



ROVOS RAIL

The Most Luxurious Train in the World

AN UNFORGETTABLE JOURNEY ON THE WORLD'S MOST LUXURIOUS TRAIN

Experience the extravagant elegance of rail travel on the most luxurious train in the world. Rovos Rail's unique train safaris through the heart of Africa combine some of the most magnificent scenery with the glamour and excitement of the golden age of rail travel. These beautifully rebuilt trains offer accommodation of the highest standard, combining the opulence of a bygone era with subtle modern innovations. Rovos Rail owns and operates St James Manor and St James Seaforth, two stately seaside retreats in St James, Cape Town.



Rovos Rail Tours (Pty) Ltd
is the proprietor of registered trademarks
for its name and logos.
Alterations or additions are strictly prohibited.

ROVOS RAIL HEAD OFFICE

PO BOX 2837, PRETORIA 0001, GAUTENG SOUTH AFRICA

TEL: (+27 12) 315 8242 FAX: (+27 12) 323 0843

ROVOS RAIL CAPE TOWN

PO BOX 50241, WATERFRONT CAPE TOWN 8002, SOUTH AFRICA

TEL: (+27 21) 421 4020/1 FAX: (+27 21) 421 4022

EMAIL: reservations@rovos.co.za

ST JAMES MANOR & ST JAMES SEAFORTH

108 & 96 MAIN ROAD, ST JAMES 7946, CAPE TOWN

TEL: (+27-21) 788 4543 FAX: (+27 - 21) 788 9590

EMAIL: guesthouses@rovos.co.za

www.rovos.com www.capetocairo.com

www.stjamesguesthouses.com



03/2012



1 1924 DINING CAR 'SHANGANI' No.195

ROVOS RAIL THE PRIDE OF AFRICA



FIRST CLASS TRAVEL

STEP ABOARD THE PRIDE OF AFRICA, THE WORLD'S MOST LUXURIOUS TRAIN,
AND BEGIN A JOURNEY TO SOUTHERN AFRICA'S MOST SPECTACULAR DESTINATIONS

Since its establishment in 1989, Rovos Rail has earned an international reputation for its truly world-class travel experiences. Step aboard the wood-panelled coaches – classics remodelled and refurbished to mint condition – and enjoy fine cuisine in five-star luxury as some of the most varied scenery imaginable unfolds beyond the windows. Recapture the romance and atmosphere of a bygone era when privileged travellers experienced the magic and mystery of Africa in a relaxed and elegant fashion. In a series of train journeys lasting from 48 hours to a month, the Pride of Africa links some of Africa's greatest destinations from Cape Town at the tip of Africa to Dar es Salaam in Tanzania, from scenic splendours as diverse as the game reserves of Mpumalanga to the Victoria Falls, from the desert landscapes in Namibia and the stark beauty of the Karoo to the lush cane fields of KwaZulu-Natal and the magnificent Garden Route along the Cape south coast. The trains – which may be hauled by steam, diesel or electric locomotives at various stages of the journey – carry a maximum of 72 passengers in 36 superbly appointed suites. Pride of place in the Rovos stable goes to the historic and restored station and locomotive yard, which is the heart and headquarters of this private railway company.

*"I never travel
without my diary.
One should always have
something sensational
to read in the train."*

~ OSCAR WILDE

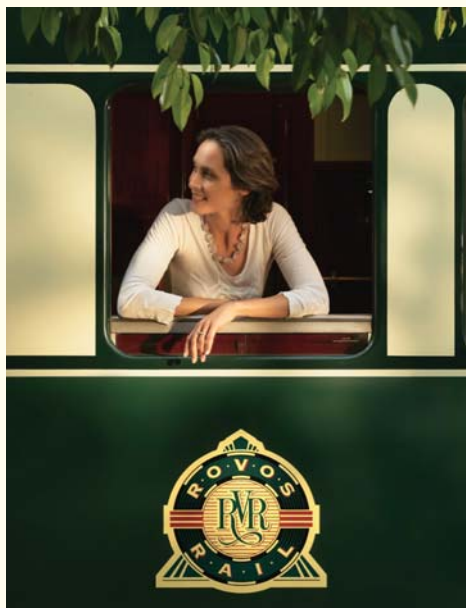

The Most Luxurious Train in the World

ROVOS RAIL THE PRIDE OF AFRICA 2



3 *The Most Luxurious Train in the World*



CAPE TOWN JOURNEY

DISCOVER INFINITE VARIETY FROM THE MOUNTAINS,
BUSHVELD AND GRASSLAND PLAINS TO THE BUSTLING
URBAN HEART OF SOUTH AFRICA'S CITIES

For many visitors to South Africa, there is no finer way to see the country than on the popular 51-hour weekly journeys between Pretoria and Cape Town. This 1 600-kilometre meander is a perfect illustration of South Africa as a world in one country. Travel the grasslands of the gold-rich Highveld to the haunting barrenness of the Great Karoo; trundle through the spectacular mountain ranges and scenic winelands of the Cape. Journey's end is Cape Town, the Mother City of South Africa, cradled by the imposing bulk of Table Mountain, Devil's Peak and Lion's Head. Highlights of the north- and southbound routes include a visit to the historic village of Matjiesfontein; this authentic perfectly preserved Victorian Village, which was founded by Mr Logan as a refreshment stop in 1890, also boasts an impressive museum on the platform. Another stop is made in Kimberley providing an opportunity to enjoy a city tour and a visit to the Diamond Mine Museum and the world's largest man-made excavation, the Big Hole.

*"There is always
something new
out of Africa."*

~ PLINY THE ELDER



PRETORIA • KIMBERLEY • MATJIESFONTEIN • CAPE TOWN



CAPITAL PARK STATION PRETORIA

PRETORIA – CAPE TOWN

DAY 1

15h00 Depart from Rovos Rail Station, Pretoria.

DAY 2

09h45 Arrive in Kimberley. Passengers visit the Big Hole and the Diamond Museum.

12h30 Depart Kimberley and proceed overnight via De Aar and Beaufort West for Matjiesfontein.

DAY 3

08h15 Visit the historic village of Matjiesfontein.

10h30 Depart Matjiesfontein and proceed via Touws River, De Doorns and Worcester to Cape Town.

18h00 Arrive Cape Town Station, Platform 24.

CAPE TOWN – PRETORIA

DAY 1

11h00 Depart from Platform 23 at Cape Town Station and proceed inland to Worcester.

18h00 Guests visit the quaint historic village of Matjiesfontein.

DAY 2

14h30 Upon arrival in Kimberley board the bus for a tour of the Big Hole and the Diamond and Mine Museum.

16h30 Depart Kimberley.

DAY 3

12h00 Arrive at Rovos Rail Station in Pretoria.

An optional link to Victoria Falls is available when travelling from Cape Town to Pretoria and vice versa.



THE LOUNGE CAR



*"Two roads
diverged in a wood,
and I - I took the one
less travelled by,
and that has made all
the difference."*

~ ROBERT FROST



VICTORIA FALLS JOURNEY

RELIVE THE ROMANCE OF A BYGONE AFRICA ON A NOSTALGIC EXPEDITION
TO ONE OF THE SEVEN NATURAL WONDERS OF THE WORLD

Experience a 1 600-kilometre journey through diverse and truly African scenery as Rovos Rail's luxurious train meanders westwards through Mafikeng into Botswana and then north towards Mahalapye, crossing the Tropic of Capricorn just after Gaborone. Once the train has passed through the dry reaches of Botswana it arrives at Plumtree in the late afternoon for border formalities with Zimbabwe. Continuing in a northwesterly direction, the train passes Bulawayo heading towards Thompson's Junction and Hwange Game Reserve, where animals can be spotted from the train. The Falls and the elegant colonial-style Victoria Falls Hotel form an ideal destination. The surrounding area offers travellers many recreational opportunities including cruises, whitewater rafting on the Zambezi River as well as superb game viewing and photo safaris. Please note that depending upon the railway's capacity this journey could be routed northwards through Beitbridge and Zimbabwe.



THE OBSERVATION CAR



PRETORIA – VICTORIA FALLS

DAY 1

- 09h30 Depart from Rovos Rail Station, Pretoria.
- 13h00 Lunch is served in the dining car/s en route to Zeerust.
- 19h30 After traversing the Magaliesberg Range, dinner is served as the train heads towards Mafikeng for border formalities.

DAY 2

- 07h00 Breakfast is served in the dining car/s.
- 13h00 Lunch is served in the dining car/s as the train heads for the Zimbabwe border.
- 17h00 Border formalities at Plumtree.
- 19h30 Dinner is served in the dining car/s.

DAY 3

- 07h00 Breakfast is served in the dining car/s.
- 13h00 Lunch is served in the dining car/s.
- 17h00 Arrive at the Victoria Falls where the Rovos Rail journey ends.

This journey is available in reverse departing Victoria Falls 10h00 on Sunday, arriving Pretoria 17h00 Tuesday. An optional link to Cape Town is available when travelling from Victoria Falls to Pretoria and vice versa.



DURBAN SAFARI

AN UNFORGETTABLE TRAIN JOURNEY
INTO THE HEART OF THE AFRICAN BUSHVELD

*"Life is a train.
Get on board."*

~ KHALED HOSSEINI
The Kite Runner



Join this three-day Safari on the most luxurious train in the world and experience the splendour of KwaZulu-Natal. Take in the Big Five, a battlefields tour with a world-class historian and unusual African ceramics. Experience the Nambiti Conservancy – a Big Five private bush retreat set on 20 000 acres of malaria-free bushveld in KwaZulu-Natal. It has an incredible biodiversity including savannah, grasslands, thornveld and tall acacia trees. The Sundays River flows through the reserve and has two 40-metre waterfalls with magnificent ravine bush, home to several rare bird species. Situated on an expansive game farm, Spionkop Lodge – which adjoins an 11 000-acre nature reserve – is the perfect base for exploring the mountains, bush, birds and battlefields of the region. The turn-of-the-century farmhouse has been beautifully restored in the Natal colonial style and the converted barn now forms a magnificent dining room that boasts spectacular views. Ardmore Ceramic Art is a story about the Zulu people whose sense of rhythm, colour, dance and song, as well as the spirit of the African imagination, is exerting its influence on the other continents of the world. Visit this charming centre in the rolling hills of Caversham in the Midlands.

PRETORIA • LADYSMITH • SPIONKOP • ESTCOURT • NAMBITI • ARDMORE • DURBAN

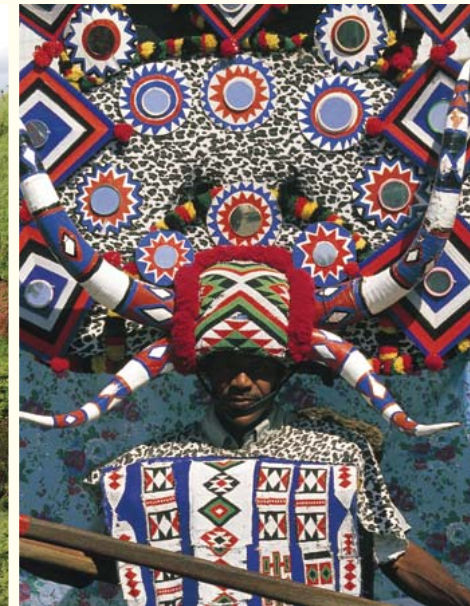

7 *The Most Luxurious Train in the World*

ROVOS RAIL THE PRIDE OF AFRICA

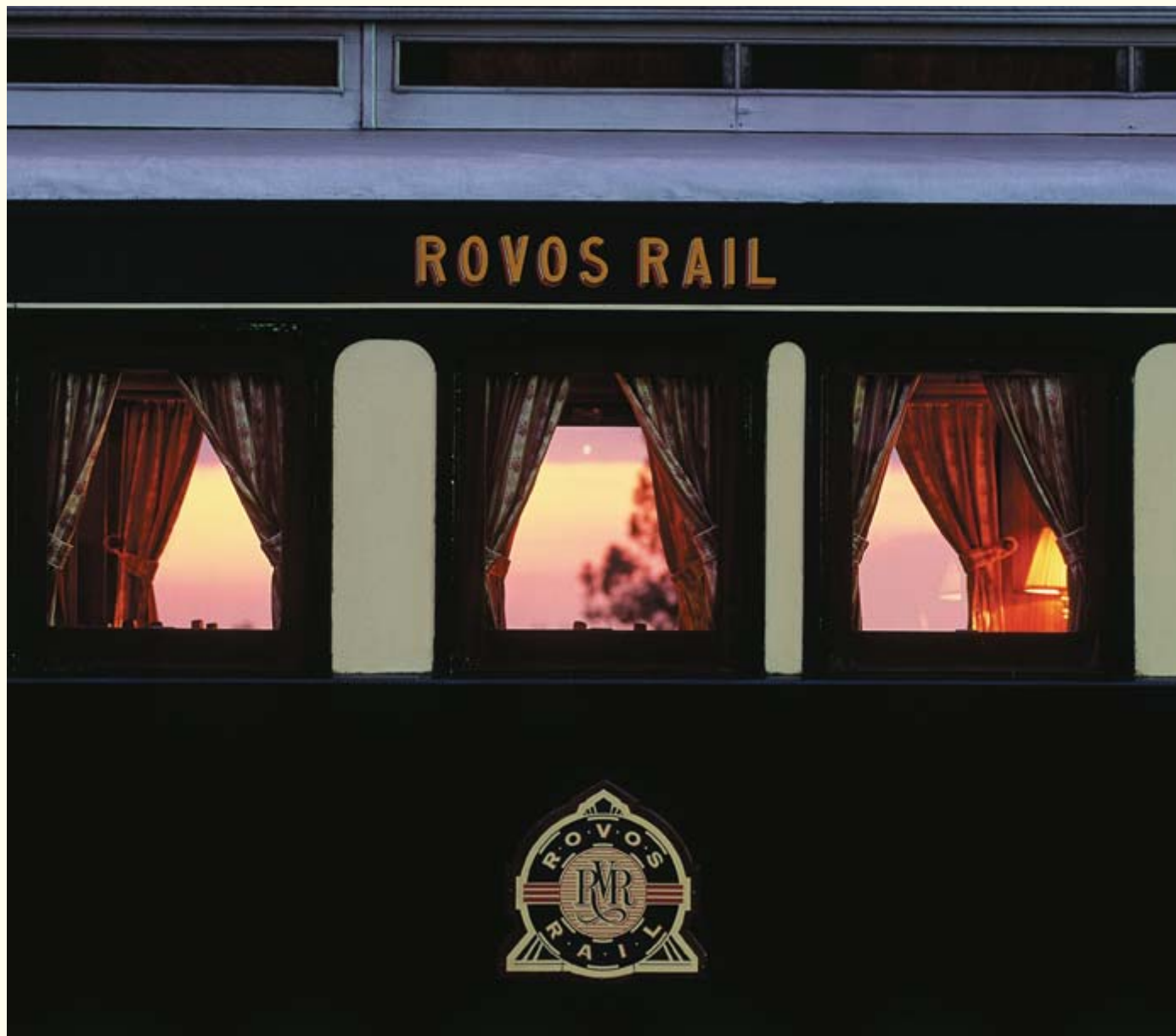

EDWARDIAN COACH

PRETORIA – DURBAN

DAY 1

- 10h00 Depart from Rovos Rail Station, Pretoria.
- 13h00 Lunch is served in the dining car/s.
- 19h30 Dinner is served en route to Elandslaagte near Ladysmith.

DAY 2

- 06h00 Wake-up call for an early morning game drive in the Nambiti Private Game Reserve.
- 11h00 Brunch is served in the dining car/s.
- 14h00 Disembark for a choice of excursions:
Option 1 – Game drive in Spionkop Game Reserve.
Option 2 – Spionkop battlefields escorted tour.
- 18h30 Return to the train.
- 19h30 Dinner is served en route to Estcourt.

DAY 3

- 07h00 Breakfast is served as the train descends the escarpment en route to Lions River Station.
- 10h00 Visit to the famous Ardmore Ceramics gallery including an equestrian display (show events permitting) and tea.
- 12h00 The train departs for Pietermaritzburg.
- 13h00 Lunch is served as the train traverses the spectacular Valley of a Thousand Hills.
- 16h00 Arrive in Durban.

This journey is available in reverse departing Durban 10h00 on Monday, arriving Pretoria 16h00 Wednesday. An optional link to Victoria Falls is available when travelling from Durban to Pretoria.

PRETORIA – SUN CITY – PRETORIA

DAY 1

10h00 Depart from Rovos Rail Station, Pretoria.

18h30 Arrive Waterval Onder.
Lunch, dinner and overnight on the train.

DAY 2

08h00 18 holes of golf at Leopard Creek.
Non-golfers game drive in the Kruger Park followed by lunch at Casterbridge Lifestyle Centre.

14h00 Train departs for Swaziland.

DAY 3

08h30 Tee off at Royal Swazi Club near Manzini.
Non-golfers visit Ngwenya Glass Factory, lunch at the Malandelas followed by a game drive in Mkhaya Game Reserve.

DAY 4

06h00 Game drive in the Hluhluwe Game Reserve, Zululand.

18h00 Arrive in Durban for overnight in the city.

DAY 5

08h30 Tee off at Durban Country Club Beachwood Course. Non-golfers go on a Durban city tour followed by lunch at the Golf Club.

DAY 6

07h30 Tee off at Champagne Sports Resort, Drakensberg. Non-golfers walk at Champagne Castle or enjoy a professional tour of the Battlefields near Ladysmith.

DAY 7

Day at leisure on the train.

DAY 8

08h00 Tee off at Gary Player Lost City Country Club, Sun City. Non-golfers explore Sun City and lunch at the Lost City CC.
15h30 Game drive in Pilanesberg Reserve.

DAY 9

07h00 Depart Rustenberg.

10h00 Arrive Pretoria.

Four departures annually.





GOLF SAFARI

A SELECTION OF THE FINEST COURSES IN SOUTH AFRICA ARE BROUGHT TOGETHER IN A KALEIDOSCOPE OF GOLF AND SCENIC BEAUTY

Rovos Rail has designed a delightful nine-day Golf Safari to entertain the most discerning player with optional excursions for non-playing guests at all venues. This journey begins in Pretoria and travels east towards Nelspruit. Play at Leopard Creek or visit the world-famous Kruger Park for a game drive followed by lunch. Then tee off at the Royal Swazi Golf Club in Swaziland or visit Ngwenya Glass with an afternoon game drive in Mkhaya Game Reserve. Next it is on to Zululand for game viewing in the Hluhluwe Game Reserve and overnight in Durban. Play one of South Africa's finest courses, the Durban Beachwood Club, while non-playing guests enjoy a city tour of Durban followed by lunch at the Golf Club. In the foothills of the imposing Drakensberg Mountains, 18 holes await at the Champagne Sports Resort with a guided tour of the Battlefields a further highlight for our non-golfers. Relax as the train travels north to Sun City for a full day at this renowned facility before departing for Pretoria where this memorable journey ends.

A second golf itinerary has been designed in conjunction with our African Collage. Golf courses during the nine-day journey include Leopard Creek, Royal Swazi, Durban Country Club, Bloemfontein Golf Club, Humewood in Port Elizabeth, Fancourt or Ernie Els Oubaa in George. Combine these famous courses with the finest scenery Southern Africa has to offer. See African Golf Collage on page 13.

*"Golf is a game whose aim
is to hit a very small ball into
an even smaller hole with
weapons singularly
ill-designed for the purpose."*

~ WINSTON CHURCHILL



PRETORIA • MALELANE • MANZINI • HLUHLUWE • DURBAN
DRAKENSBERG • SUN CITY • PRETORIA





*"There is something
about safari life
that makes you forget
all your sorrows..."*

~ KAREN BLIXEN - *Out of Africa*



DAR ES SALAAM JOURNEY

ROVOS RAIL'S TRANS-AFRICAN SAFARI CARRIES AN EXCLUSIVE BAND OF INTREPID TRAVELLERS

This epic 14-day journey travels through South Africa, Botswana, Zimbabwe, Zambia and Tanzania and is one of the most famous train journeys in the world. This magnificent sojourn will take you through South Africa with short tours of the diamond town of Kimberley and the capital city of Pretoria, then a two-night stay at a private lodge in the Madikwe Game Reserve. The train then crosses through Botswana into Zimbabwe where we overnight at the Victoria Falls Hotel. After crossing the mighty Zambezi River, travel northeast through Zambia joining the Tazara Railway line at Kapiri Mposhe. Enjoy a bush walk at Chisimba Falls then continue the climb towards the Zambian/Tanzanian border, almost the midpoint between Africa's two Great Rift Valley lakes. Descend into the Rift Valley itself and witness spectacular scenery as the train negotiates the tunnels, switchbacks and viaducts of the escarpment. Early on the last day, the train passes through the Selous Game Reserve – the largest on the continent and a vision of timeless Africa – shortly before the bustling arrival in Dar es Salaam. Please note that depending upon the railway's capacity this journey could be routed northwards through Beitbridge and Zimbabwe.



EN ROUTE TO DAR ES SALAAM

CAPE TOWN – DAR ES SALAAM

- DAY 1**
11h00 Depart Cape Town Station.
18h00 Arrive Matjiesfontein and explore the quaint village. Dinner and overnight on the train.
- DAY 2**
14h30 Upon arrival in Kimberley board the buses for a tour of the Big Hole and Diamond Museum.
- DAY 3**
11h30 Arrive Pretoria for lunch and city tour.
- DAY 4**
11h00 Arrive Zeerust for a full-board overnight stay at a five-star game lodge.
- DAY 5**
After breakfast, guest activities. Lunch, dinner and overnight at the lodge.
- DAY 6**
06h00 Early morning game drive.
12h00 Depart Gaborone. Lunch, dinner and overnight on the train.
- DAY 7**
06h00 Arrive Plumtree for border formalities. Breakfast, lunch, dinner and overnight on the train. Lecture 1 and 2.
- DAY 8**
11h00 Arrive Victoria Falls and transfer to the hotel. Sunset cruise on the Zambezi River, followed by dinner and overnight at the hotel.
- DAY 9**
Day at leisure (own arrangements): tour the Falls, play a game of golf, take the Flight of the Angels or go river rafting, and so on.
15h00 Depart Victoria Falls.
- DAY 10**
13h30 Pass through Lusaka. Breakfast, lunch and dinner on board. Lecture 3 and 4.
- DAY 11**
08h00 Arrive Kasame for a bush walk at Chisimba Falls.
- DAY 12**
14h00 Arrive Tunduma for Tanzanian border control. Breakfast, lunch, dinner and overnight on the train. Lecture 5 and 6.
- DAY 13**
10h00 Arrive Makambako. Breakfast, lunch and dinner on board. Lecture 7 and 8.
- DAY 14**
10h00 Arrive Tazara Station, Dar es Salaam.

Journey available in reverse from Dar es Salaam to Cape Town.

Itineraries on request or on our website: www.rovos.com

Pre- and post-tours as well as detailed north- and southbound itineraries are available.





AFRICAN GOLF COLLAGE

A RICH TAPESTRY OF LANDSCAPE, GAME, HISTORY AND CULTURE INCLUDING THE WINELANDS OF THE GARDEN ROUTE AND CAPE TOWN

This panoramic nine-day sojourn commences at the Rovos Rail Station in Pretoria. The first leg of the journey takes the train through Witbank and Middleburg and then traverses the majestic Drakensberg escarpment en route to the lowveld of Mpumalanga. The following morning enjoy an early game drive through the famous Kruger Park. Brunch will be served while the train winds its way southwards to Swaziland in time for an afternoon game drive in the Mkhaya Reserve. During the night the train will continue south to the Hluhluwe Game Reserve where a wide variety of game can be seen on a scenic morning game drive, then through to Durban for overnight in the city. The train steadily ascends the escarpment through Pietermaritzburg en route to Lions River for a stop at the famous Ardmore Ceramics Gallery the next day. The route to Bethlehem takes the train past Lesotho and the highest mountains in the Drakensberg range at 3 482 metres. During the night the train continues on to Bloemfontein for a tour of the city, then southwards overnight to Port Elizabeth for a visit to the Addo Elephant Park. An early departure takes the train into Oudtshoorn to the Highgate Ostrich Farm followed by another spectacular rail descent down the Montagu pass into George. After visiting Knysna the train sets off at midday travelling the scenic Garden Route. After a stop off at the KWV Brandy Distillery in Worcester the next day, this magnificent Collage ends in Cape Town.

A second golf itinerary has been designed in conjunction with our African Collage. Golf courses during the nine-day journey include Leopard Creek, Royal Swazi, Durban Country Club, Bloemfontein Golf Club, Humewood in Port Elizabeth, Fancourt or Ernie Els Oubaai in George. Combine these famous courses with the finest scenery Southern Africa has to offer.

PRETORIA • SWAZILAND • HLUHLUWE • DURBAN • PORT ELIZABETH

13 OUDTSHOORN • KNYSNA • CAPE TOWN



CLUB LOUNGE

PRETORIA – CAPE TOWN

DAY 1

10h00 Depart Rovos Rail Station, Pretoria.

DAY 2

05h00 Wake-up call for a game drive in the Kruger Park.

15h30 Arrive Mkhaya Game Reserve, Swaziland, for an afternoon game drive.

DAY 3

06h00 Game drive in the Hluhluwe Game Reserve, Zululand.

18h00 Arrive Durban for overnight in the city.

DAY 4

06h00 Depart Durban en route to Kroonstad.

10h00 Disembark the train for a visit to the famous Ardmore Ceramics Gallery.

12h30 Return to the train for lunch and depart for an overnight stop in Kroonstad.

DAY 5

10h00 Enjoy a tour of Bloemfontein.

13h00 Depart for Port Elizabeth.

DAY 6

09h00 Tour of Addo Elephant Park near Port Elizabeth.

12h45 Return for departure to Oudtshoorn.

DAY 7

10h00 Arrive Oudtshoorn for Ostrich Farm visit.

12h00 The train departs for George.
Afternoon at leisure.

18h00 Disembark for dinner at Fancourt Estate.

DAY 8

09h00 Disembark for morning tour of Knysna.

13h30 Depart for George.

DAY 9

11h00 Arrive in Worcester for a KVV Brandy Distillery tour. Depart for a 17h00 arrival at Platform 23, Cape Town Station.

Annually in May/June.



The Most Luxurious Train in the World

EN ROUTE THROUGH THE HEX RIVER VALLEY 14



NAMIBIA SAFARI

AN EPIC JOURNEY OF DISCOVERY REUNITING BY RAIL THE REPUBLICS OF SOUTH AFRICA AND NAMIBIA

Each year this nine-day 3 400-kilometre journey takes the train from the savannahs of the Highveld to the Atlantic Ocean. The Pride of Africa departs from Pretoria for Kimberley, centre of one of the world's most famous diamond rushes, where there is an opportunity to visit the Big Hole and savour the 1870s atmosphere of the mine museum village. Then enjoy a walking tour of Upington, the principal town of the Northern Province bound by the Orange River and the Kalahari Desert. The railway line then covers the stark vistas of the arid Northern Cape into Namibia at Ariamsvlei. There is an excursion to the spectacular Fish River Canyon – second in size to the Grand Canyon and truly a spectacular sight. A short visit to Keetmanshoop offers another opportunity for a walking tour as we visit this small but important sheep-farming town. The train continues across the Kalahari Desert to Namibia's capital, Windhoek – a lively, cosmopolitan city with a strong German flavour. A highlight is the 24-hour excursion to the world-famous Sossusvlei, a stunning pan in the Namib Desert surrounded by massive red sand dunes. After a night's stay at Sossusvlei, guests rejoin the train in Windhoek and continue overnight to Tsumeb and the Etosha National Park. A night is spent at the Mokuti Game Lodge on the eastern edge of the game-rich park. The journey then continues on to Swakopmund, a perfectly preserved 19th-century German Hansa town set between the dunes of the Namib desert and the roaring Atlantic Ocean – an unforgettable end to a remarkable journey.

*"A good traveller
has no fixed plans,
and is not intent
on arriving."*

~ LAO TZU



PRETORIA • KIMBERLEY • FISH RIVER CANYON • WINDHOEK

SOSSUSVLEI • SWAKOPMUND



DELUXE SUITE WITH DOUBLE BED



PRETORIA – SWAKOPMUND

DAY 1

15h00 Depart from Rovos Rail Station, Pretoria.

DAY 2

10h00 Arrive in Kimberley for a tour of the Big Hole and Diamond Museum.

12h45 Depart Kimberley.

DAY 3

08h00 Arrive in Upington for a walking tour.

23h00 Arrive in Holoog Siding.

DAY 4

08h00 Visit to the Fish River Canyon.

11h00 Arrive Keetmanshoop for walking tour.

17h00 The train departs for Windhoek.

DAY 5

09h00 Arrive in Windhoek for a city tour.

11h00 Depart Windhoek in light aircraft for a 1-hour scenic flight to Sossusvlei. Lunch, desert drive, bush dinner and overnight.

DAY 6

06h00 Excursion with breakfast in Sossusvlei.

12h00 Depart for 1-hour flight to Windhoek.

14h00 Train departs Windhoek.

DAY 7

10h40 Arrive in Tsumeb. Transfer to Mokuti Lodge in Etosha National Park. Lunch, game drive and overnight.

DAY 8

06h00 Early morning game drive in Etosha.

13h00 Depart Tsumeb.

DAY 9

11h00 Arrive in Swakopmund.

Journey available in reverse from Swakopmund to Pretoria.



SOUTHERN AFRICA AIR CHARTER

TOUR SOUTHERN AFRICA IN A MAGNIFICENT CLASSIC AIRCRAFT

A suitable aircraft and dedicated crew accompanies guests on this superb and exclusive adventure, which includes two nights at six outstanding venues. An optional pre-air tour has been designed to include two nights in Stellenbosch and two nights on Rovos Rail between Cape Town and Pretoria. The 12-night Air Charter departs from Wonderboom Airport in Pretoria with two nights at Phinda Game Reserve followed by two nights at Hunters Country Lodge in Plettenberg Bay. Enjoy a scenic drive to the Tsitsikamma National Park and Storms River with an evening cruise on the Knysna lagoon. Then it's on to Cape Town with an afternoon tour of the city and Table Mountain Cableway. Two nights will be spent at the Cape Grace Hotel at the Victoria & Alfred Waterfront with a day tour of the Cape Peninsula and the Winelands. The Charter then flies on to Lüderitz in Namibia, followed by a flight over Sossusvlei and two nights at the the Wolwedans Dunes Lodge. Next it is on to the Okavango Delta for two nights in this exquisite wilderness. A short flight takes guests to the Royal Livingstone Hotel and the Victoria Falls for a two-night stay after which the unique five-star 13-day journey ends with a flight to Lanseria Airport.

PRETORIA • PHINDA • PLETTENBERG BAY • CAPE TOWN • SWAKOPMUND • MAUN • VICTORIA FALLS



*"Do not go where the path
may lead; go instead
where there is no path and
leave a trail."*

~ RALPH WALDO EMERSON





THE HEADS AT KNYSNA LAGOON



SOUTHERN AFRICA AIR CHARTER

DAY 1
12h00 Guests meet at Rovos Rail Station in Pretoria for introduction and a short tour of railway depot.
14h00 After lunch transfer to Wonderboom Airport. Board aircraft for 1-hour flight to lodge.
15h30 Transfer to Phinda Private Game Reserve with an afternoon game drive. Overnight at lodge.

DAY 2
06h00 Early morning and late afternoon game drives. Overnight at lodge.

DAY 3
11h00 Transfer to airport for 3-hour flight to Plettenberg Bay for a 2-night stay at Hunters Country House.

DAY 4
09h00 Scenic drive and tour of Tsitsikamma National Park and Storms River. Return to Hunters after lunch to freshen up and change for a sundowner lagoon cruise in Knysna. Dinner on the boat.

DAY 5
09h00 Depart for Cape Town. Arrive Cape Grace Hotel at the Victoria & Alfred Waterfront. Tour of city and Table Mountain Cableway (weather permitting). Dinner at the hotel.

DAY 6
09h00 After breakfast, depart for a guided tour of Cape Peninsula/Winelands/Robben Island.
13h00 Lunch in Constantia Valley. Late afternoon and hotel dinner at leisure.

DAY 7
08h00 After breakfast transfer to the airport for the flight to Lüderitz in Namibia.
11h00 Arrive in Lüderitz and after a tour and lunch take a short drive to visit the mining ghost town of Kolmanskop.
15h00 Depart Lüderitz for the scenic flight over Sossusvlei to Wolwedans. Transfer to Dunes Lodge.

DAY 8
08h00 After breakfast, depart for scenic drive in desert or nature walk. Hot-air ballooning is available at an extra cost.
16h00 Enjoy sundowners in the desert followed by dinner.

DAY 9
08h00 Transfer to airport for 3-hour flight via Skeleton Coast to Maun in Botswana.
12h00 Fly in light aircraft to various camps in the Okavango Delta. Guest activities: guided walk, game drive or mokoro (canoe) trip with late afternoon wilderness experience. Overnight at the camp.

DAY 10
Guest activities: guided walk, game drive or mokoro (canoe) trip. After brunch there is time for a siesta before the late afternoon outing. Overnight at the camp.

DAY 11
10h30 Light aircraft transfer to Maun. Depart Maun for 1-hour flight to Livingstone in Zambia.
13h00 Transfer to the Royal Livingstone Hotel at the Victoria Falls.
16h00 Sunset cruise on the Zambezi River. Dinner and overnight at hotel.

DAY 12
Day at leisure. Farewell dinner and overnight at hotel.

DAY 13
08h00 Transfer to Livingstone airport for 3-hour flight to Lanseria Airport in Johannesburg.

Four-day pre-air tour also available.



CAPE TO CAIRO

NOW THESE TWO HISTORICALLY LINKED
AFRICAN CITIES ARE JOINED TOGETHER BY ROVOS RAIL'S
TRANS-AFRICAN SAFARI

Rovos Rail has designed the ultimate African experience for this exclusive five-star journey, which includes the incomparable luxury of Rovos Rail and a comfortable aircraft. This 28 day African expedition will carry an exclusive band of intrepid adventurers through the heartlands of South Africa, Botswana, Zimbabwe, Zambia, Tanzania, Uganda, the Sudan and Egypt.

The northbound route includes our epic Cape Town to Dar es Salaam train journey. Thereafter join our air safari and continue north from Dar es Salaam to Zanzibar and then into the heartland of Tanzania where a four-day visit to the Ngorongoro Crater and the Serengeti await you. Continue onto Entebbe, Uganda, and enjoy an optional visit to the chimpanzees and the source of the Nile. Your journey then follows the Nile northwards to Khartoum in the Sudan and onto Abu Simbel in Egypt. A luxurious lake cruiser will take you in a leisurely fashion over three nights to see the historical sights on the shores of Lake Nasser. Then it is on to Luxor for two nights to experience ancient Egypt in all its splendour as you visit temples, quarries and the Valley of Kings and Queens. Rejoin the aircraft for the last leg to Cairo where your adventure ends as you tour the Pyramids, Sphinx and the Egyptian Museum of Antiquities from the exquisite Four Seasons First Residence Hotel.

The southbound air safari route begins in Cairo as you tour the Pyramids, Sphinx and the Egyptian Museum of Antiquities from the exquisite Four Seasons First Residence Hotel. Then it is on to Luxor for two nights to experience ancient Egypt in all its splendour as you visit temples, quarries and the Valley of Kings and Queens. A luxurious lake cruiser will take you in a leisurely fashion over three nights to see the historical sights on the shores of Lake Nasser. Your journey then follows the Nile from Abu Simbel southwards to Khartoum in the Sudan. After two days are spent exploring this ancient city continue onto Entebbe, Uganda, and enjoy an optional visit to the chimpanzees and the source of the Nile. Fly into the heartland of Tanzania where a four-day visit to the Ngorongoro Crater and the Serengeti await you. Visit the exotic island of Zanzibar for two days before flying onto Victoria Falls, Zimbabwe, to join Rovos Rail for your four-night train journey to Cape Town.

CAPE TOWN • PRETORIA • BOTSWANA • VICTORIA FALLS • DAR ES SALAAM
ZANZIBAR • SERENGETI TANZANIA • ENTEBBE UGANDA • KHARTOUM SUDAN
ABU SIMBEL • LAKE NASSER • LUXOR • CAIRO

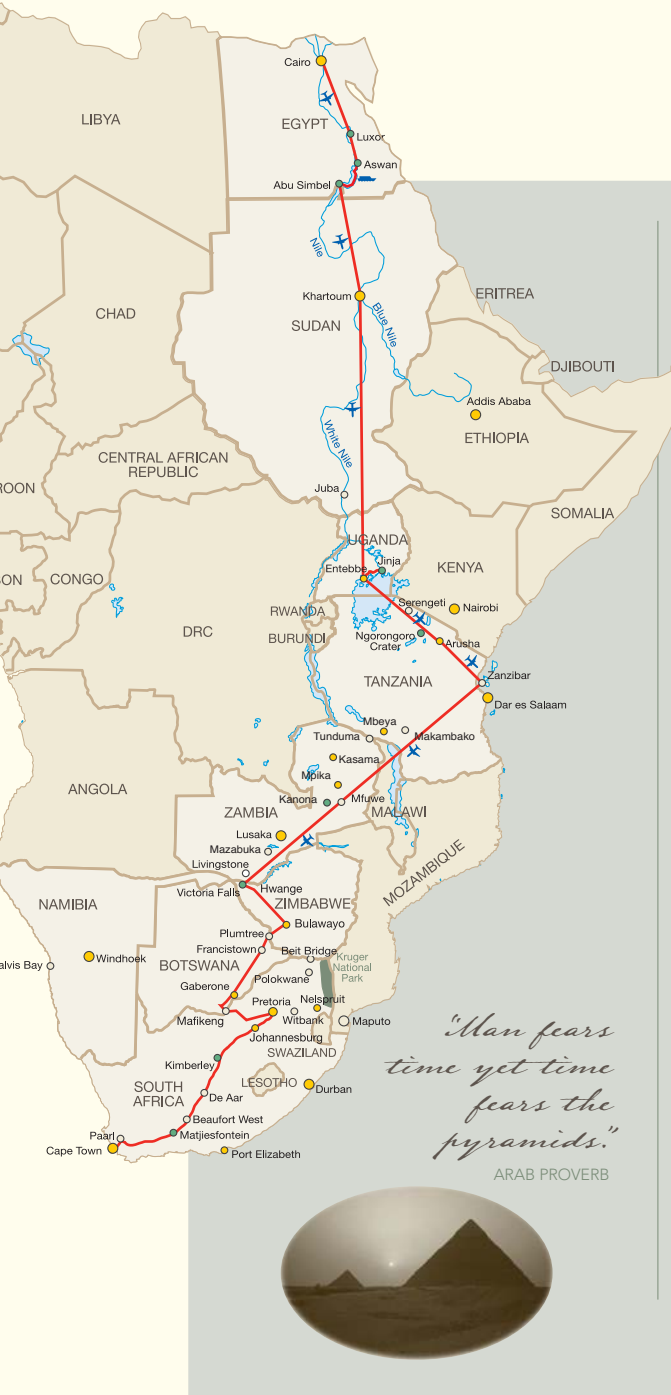

CAPE TO CAIRO 28-DAY ITINERARY

- DAY 1 Arrive Cape Town
- DAY 2 Tours Cape Town
- DAY 3 Tours Cape Town
- DAY 4 Train departs Cape Town. Matjiesfontein excursion.
- DAY 5 Kimberley tour.
- DAY 6 Pretoria city tour. Overnight Pretoria.
- DAY 7 Board Rovos Rail. Overnight train.
- DAY 8 Breakfast, lunch, dinner and overnight on train.
- DAY 9 Arrive Victoria Falls. Overnight hotel.
- DAY 10 Victoria Falls activities.
- DAY 11 Fly Victoria Falls to Zanzibar. Stone Town tour.
- DAY 12 Island spice tour. Overnight Zanzibar.
- DAY 13 Fly Zanzibar to Kilimanjaro to Ngorongoro.
- DAY 14 Game drive and picnic lunch on floor of crater .
- DAY 15 Transfer to Masek tented camp in Serengeti.
- DAY 16 Game drives morning and afternoon.
- DAY 17 Fly Serengeti to Kilimanjaro to Entebbe, Uganda. Chimpanzee or source of the Nile excursions.
- DAY 18 Chimpanzee or source of the Nile excursion.
- DAY 19 Fly Entebbe to Khartoum, Sudan.
- DAY 20 Full- or half-day tours, Khartoum.
- DAY 21 Fly to Abu Simbel, Egypt. Lake Nasser cruise.
- DAY 22 Lake Nasser cruise. Antiquities tours.
- DAY 23 Lake Nasser cruise. Antiquities tours.
- DAY 24 Road transfer to Luxor. Antiquities tours. Overnight Luxor.
- DAY 25 Antiquities tours. Overnight Luxor.
- DAY 26 Fly to Cairo. Tours Cairo.
- DAY 27 Tours Cairo.
- DAY 28 28 day tour ends.

CAIRO TO CAPE 28-DAY ITINERARY

- DAY 1 Arrive Cairo Airport.
- DAY 2 Tours Cairo.
- DAY 3 Morning tours Cairo. Fly to Luxor. Tours Luxor.
- DAY 4 Tours Luxor.
- DAY 5 Road transfer to Aswan. Lake Nasser cruise.
- DAY 6 Lake Nasser cruise. Antiquities tours.
- DAY 7 Lake Nasser cruise. Antiquities tours.
- DAY 8 Morning antiquities tours. Fly Abu Simbel to Khartoum, Sudan.
- DAY 9 Full- or half-day tours, Khartoum.
- DAY 10 Fly to Entebbe, Uganda. Chimpanzee or source of the Nile excursions.
- DAY 11 Chimpanzee or source of the Nile excursions.
- DAY 12 Fly to Kilimanjaro, Tanzania. Road transfer to Ngorongoro.
- DAY 13 Game drive and picnic lunch on crater floor.
- DAY 14 Transfer to Masek tented camp, Serengeti.
- DAY 15 Game drives morning and afternoon.
- DAY 16 Fly Serengeti to Kilimanjaro to Zanzibar. Stone Town tour.
- DAY 17 Island Spice tour.
- DAY 18 Fly Zanzibar to Victoria Falls, Zimbabwe.
- DAY 19 Victoria Falls activities.
- DAY 20 Board Rovos Rail. Overnight train.
- DAY 21 Breakfast, lunch, dinner, overnight on train. Dinner and overnight.
- DAY 22 City and Rovos Rail Station tours. Depart for Cape Town.
- DAY 23 Kimberley tour.
- DAY 24 Matjiesfontein excursion. Train arrives Cape Town. Overnight hotel.
- DAY 25 Tours Cape Town.
- DAY 26 Tours Cape Town.
- DAY 27 Tours Cape Town.
- DAY 28 28-day tour ends.

For detailed itineraries and dates please visit our website www.rovos.com or contact reservations@rovos.co.za







PRIVATE HIRE

UNIQUE TRAIN SAFARIS FOR CHARTER, PRIVATE FUNCTIONS AND CORPORATE TOURS

The newly rebuilt Rovos Rail Events Train is an ideal venue for corporate clients to stage conferences, incentives or product launches. The train accommodates up to 250 guests and is only suitable for daytime journeys. Limited only by time and distance, there are many alternative uses for the train, which include a three-hour circular trip around Pretoria or a one-way journey to any destination within eight hours' rail travel time from Pretoria. Depending on the number of guests, the Events Train can host, with full-bar facilities, a five-course sit-down dinner for up to 96 guests, a three-course sit-down meal for up to 192 guests in two sittings or, for 250 guests, hot snacks, canapés and cocktails served for the duration of the journey. There are also many permutations using Rovos Rail's 44-bed or 72-bed train. From our headquarters in Pretoria, successful overnight trips from one to 10 days have been undertaken with incentive groups, historical tours, private family gatherings and bird shoots. Within reason, and subject to availability, the chartered train can go wherever there is a railway line in Southern Africa.

The Most Luxurious Train in the World



"A private railway car is not an acquired taste. One takes to it immediately."

~ ELEANOR ROBSON BELMONT

DELUXE L TWIN



THE SUITES

ROVOS RAIL'S REBUILT SLEEPER COACHES CONTAIN THE MOST SPACIOUS TRAIN SUITES IN THE WORLD, OFFERING EVERY MODERN CONVENIENCE AND COMFORT

The epitome of luxury with handsome wood panelling and period Edwardian features, the air-conditioned suites accommodate two people offering the option of twin or spacious double beds. In the en-suite bathrooms, original fittings combine with the modern technology of hot showers, hair dryers and shaver plugs. The Royal Suites, each of which take up half a carriage, are spacious and elegant, measuring ± 16 sq metres/ ± 172 sq feet in size. Each has its own private lounge area and full bathroom with Victorian bath and separate shower. The Deluxe Suites (± 11 sq metres/ ± 118 sq feet) also accommodate two passengers in either twin or double beds and have a lounge area and en-suite bathroom with shower. The Pullman Suites (± 7 sq metres/ ± 76 sq feet) are equipped with a comfortable sofa-seat during the day with a conversion to double or twin beds for the evening, and also have an en-suite bathroom with shower. The very spacious suites offer passengers the opportunity to travel in privacy, comfort and luxury, with fittings and facilities that are of the highest standard. All are equipped with a writing surface and a personal safe for valuables. There is also a bar fridge filled with beverages of the passengers' choice and room service is available 24 hours a day.



23 DELUXE CROSSWISE DOUBLE



PULLMAN DAYTIME SETTEE



ROYAL SUITE BATHROOM



A ROYAL SUITE



*"There is nothing like
a comfortable adventure
to put people in a good
humour..."*

~ PETER MAYLE



LIFE ON BOARD

LIFE ON BOARD IS SIMPLE, ELEGANT AND ENTERTAINING

An enthusiastic team of chefs is responsible for overseeing the very important task of ensuring guests' every need is catered for. There's an accent on fresh local ingredients and traditional dishes such as game are a specialty. Every morning there is a full breakfast with dishes cooked to order. Lunch and dinner are complemented by a selection of excellent South African wines and cheeses and are served in one sitting only in the charming Victorian atmosphere of the dining cars. Many of the passengers aboard enjoy the formality of fine china, crisp linen and silver, and dress accordingly. During the day dress is more casual with cool, comfortable clothes and hats recommended for the excursions, especially in the game reserves where it can get very hot. The Observation Car seats 32 passengers and is positioned at the rear of the train, while at the centre of the train we have, when numbers dictate, a non-smoking Lounge Car that seats 26 passengers in comfort. A smoking Club Lounge is placed next to the Observation Car and seats 11. Maintaining the spirit of travel of a bygone era, there are no radios or television sets on board.





1924 DINING CAR 'SHANGANI' No.195





FULL STEAM AHEAD

SEVEN SUPERBLY RECONDITIONED LOCOMOTIVES ARE
THE SOUL OF ROVOS RAIL AND A SIGHT TO GLADDEN
THE HEART OF ANY RAIL ENTHUSIAST

There's a story behind the acquisition and restoration of every one of the Rovos Rail locomotives. Each one has a distinctive character and charm and are all named after owners Rohan and Anthea Vos' family. The oldest engine in the stable is also the smallest: 439 TIFFANY – named after their youngest daughter – is one of 40 Class 6 locomotives manufactured by Dubs & Co in 1893. Rohan Vos first saw this petite locomotive on the platform of Winburg Station in the eastern Free State and it was love at first sight. It was purchased in 1987 and Dunns Locomotive in Witbank was commissioned to return the Class 6 to running condition. 2701 BRENDA, 2702 BIANCA and 3360 SHAUN are named after Rohan and Anthea's other three children. They are Class 19D locomotives, which were all built during the 1930s. All three locomotives were saved from scrap-metal dealers and, after extensive restoration by Dunns Locomotive and the Rovos staff, were put back into service in 1989. Loco 3484 MARJORIE – named after Rohan's mother – is a Class 25NC locomotive built in 1954 by North British in Glasgow. Due to the difficulties in running steam locomotives over long distances in South Africa, the decision was made to convert this locomotive from a coal- to an oil-fired engine. She can cover a distance of 200 kilometres without needing to stop for oil or water, whereas the coal-fired locomotives need to stop for water every 80 kilometres. A highlight of the official opening of the new Capital Park Station on 7 May 1999 was the christening ceremony performed by Mrs Marjorie Vos, launching this magnificent locomotive into service. A further two Class 25NC locomotives have been restored and added to the fleet: 3442 ANTHEA, built in 1953 by Henschel of Germany, is named after Rohan's wife; 3533 KING ZOG is named after Rohan's Dalmatian.



*"I travel not to
go anywhere, but to go.
I travel for travel's sake.
The great affair is to move."*

~ ROBERT LOUIS STEVENSON

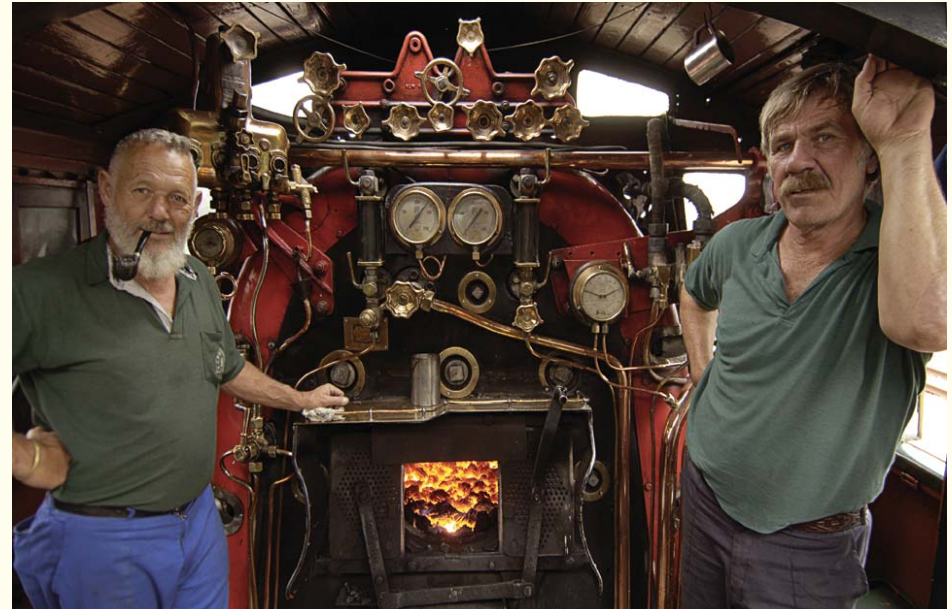



*"Boy, have I got
a great train set."*

~ ROHAN VOS



ROVOS RAIL STATION

THE REBUILT 60-ACRE PROPERTY IS NOW A GRACIOUS COLONIAL-STYLE
RAILWAY STATION, HOME AND HEADQUARTERS FOR ROVOS RAIL

For Rovos Rail passengers, a highlight of their journey is a visit to the private station at Capital Park, Pretoria. The once bustling hub of steam locomotion in the old Transvaal is now the headquarters for Rovos Rail. The gracious colonial-style railway station serves as the new departure or arrival point for all train journeys. The property boasts a small railway museum in addition to its other comprehensive facilities and will, with the addition of semaphore signals and a footbridge, recreate the atmosphere of a fully fledged railway system. It is intended that, with time, this facility should become the foremost working train museum in the world. The eyes of rail enthusiasts will be drawn to the vast carriage and locomotive sheds where teams of dedicated personnel keep the rolling stock in perfect order. This roofed workshop of 10 000 sq metres straddles 15 railway lines with concrete inspection pits below, and is the ultimate repair and maintenance facility for any train operation. The low, red-bricked buildings alongside the new 300-metre platform house laundries, gleaming stainless-steel kitchens and well-stocked storerooms. This is the busy hub of a provisioning operation, which rivals that of a world-class hotel in terms of efficiency and attention to detail.

1966 ELECTRIC LOCOMOTIVE 5E1, 3000 VOLTS DC





CAPITAL PARK STATION PRETORIA – 60 ACRES – ROVOS RAIL HEADQUARTERS

Steam

Officially opened in 1943, Capital Park, with its locomotive sheds and marshalling yard, played a vital roll in the rail network around Pretoria before falling into disuse. Technology and time moved on and over the years newer forms of railway locomotion replaced the old and faithful steam engines, which had served so well since the industrial revolution. With the arrival of electric and diesel engines, the steam locomotive sheds at Capital Park experienced a steady decline.

Use of steam has become increasingly difficult over the past years, as more and more water and coaling facilities have been scrapped. Where facilities no longer exist, diesel or electric locomotives will be used. Rovos Rail will, however, endeavour to ensure that arrivals and departures in Pretoria are steam hauled.

On 25 April 2001, an occurrence of note was recorded at Rovos Rail's yard when for the first time in South African Railway's history a private train with a private locomotive was driven and fired by its own private crew.





ROYAL SUITES

±16 SQ METRES

Bed Dimensions Royal (LxW)
DOUBLE 189x189
TWIN 189x94

DOUBLE BED



LOUNGE AREA
MINI-BAR FACILITIES
AIR-CONDITIONING
BATHROOM WITH BATH AND SHOWER
LUGGAGE SHELF, CUPBOARD AND SAFE



LOUNGE CAR



DINING CAR



DELUXE SUITES

±11 SQ METRES

Bed Dimensions Deluxe (LxW)
DOUBLE 189x189
CROSSWISE 189x160
TWIN 189x94
L-TWIN 189x90

LENGTHWAYS
DOUBLE BED



CROSSWISE
DOUBLE BED



L TWIN BEDS



MINI-BAR FACILITIES
AIR-CONDITIONING
BATHROOM WITH SHOWER
LUGGAGE SHELF, CUPBOARD AND SAFE



CLUB LOUNGE CAR

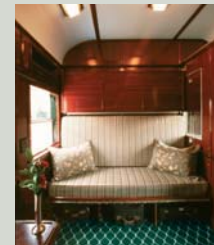

PULLMAN SUITES

±7 SQ METRES

Bed Dimensions Pullman (LxW)
DOUBLE 189x150
TWIN Lower 189x90
Upper 189x60
SINGLE Lower 189x90
Upper 189x60

DAYTIME
SOFA COUCH

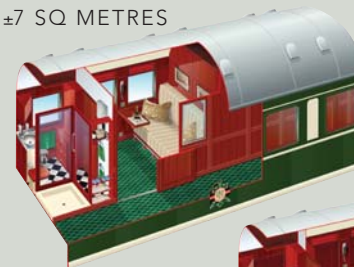

NIGHT-TIME
UPPER AND
LOWER BED

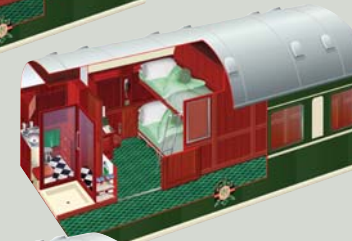

NIGHT-TIME
DOUBLE BED



MINI-BAR FACILITIES
AIR-CONDITIONING
BATHROOM WITH SHOWER
LUGGAGE SHELF, CUPBOARD AND SAFE



OBSERVATION CAR





GENERAL INFORMATION

The rate per person includes: • Three superb meals daily, all alcoholic and other beverages • Sightseeing excursions accompanied by a qualified tour guide • Entrance fees to places of interest • 24-hour full room service and bar facilities • Government tax • Limited laundry service on board the train.

Not included: Staff gratuities and off-train and aeroplane beverages.

Tour payment: A deposit of 25% of the tour price is required at the time of booking to secure confirmation • The balance is payable eight weeks before departure • Please note that group bookings of 10 passengers or more are subject to different conditions. Special conditions also apply to our annual and biannual journeys and Rovos Air charters. Please enquire.

Passports and visas: The onus is upon the client to ensure that passports and visas, as may be required, are valid.

Health: Anti-malaria precautions should be commenced before Zimbabwe, Zambia, Tanzania, Kruger Park, Swaziland and Victoria Falls departures.

Cancellation of confirmed reservations: Cancellations received more than eight weeks prior to departure are subject to a cancellation fee of 5% of the per person tour price • Cancellations received between eight weeks and four weeks prior to departure are subject to a fee of 25% of the per person tour price • Cancellations received within the four-week period are subject to forfeiture of the entire tour price.

Please note: Cancellation fees will not be waived. Trip-cancellation insurance is compulsory.

Changes: Rovos Rail reserves the right to amend the tour price at any time prior to written confirmation of the reservation. Rovos Rail further reserves the right to cancel or amend any sightseeing excursions or the tour departure dates provided they can offer the passenger alternative sightseeing excursions or departure dates. Rovos Rail is not responsible for any delay or changes in tour arrangements that may be caused by natural or other factors beyond the control of Rovos Rail. There will be no refunds for any part of the tour that might be missed due to personal reasons.

Security: There is a guest safe in every suite on board the train.

Dress on board the train: During the day, the dress is smart casual • Comfortable clothes are essential for game reserves and the African bush. Please include warm clothing for cold mornings and evenings • In keeping with the dignified atmosphere of the train, many guests prefer to dress for dinner. Evening attire might therefore be included in a guest's luggage • A jacket and tie is a minimum requirement please.

Electricity on the train: 220V AC 50Hz • 3-point round-pronged wall plug • 110V 2-prong plug.

Smoking: Smoking of cigarettes and cigars is only allowed in the privacy of the suites and in the club lounge • We request that **extreme caution** be exercised when smoking in the suites • We further request that guests show due consideration for non-smokers in public areas • Smoking is prohibited on board the aeroplanes.

General: It is not advisable to lean out of the windows while the train is in motion • Also please bear in mind that steam locomotives emit a considerable amount of soot that is harmful to the eyes • Should guests lean out the window please use the goggles provided for your safety • Be careful of shrubbery and branches that might pass close to the train.

Children: Rovos Rail does accommodate children but we ask parents to be mindful of the sophisticated adult atmosphere we endeavour to maintain.

Rovos Rail memorabilia: There is a small gift shop on board the train and at our station premises in Pretoria.

Due to the varying exchange rates, the use of credit cards is preferred.

For full details of terms and conditions see www.rovos.com or contact Rovos Rail on +27 12 315 8242.

Design: Paddy Burke • Copy: Sarah Hetherington • Editing: Bianca Vos • Photography: Alain Proust (assisted by Denver Hendricks), Kevin Macintosh, Lambro Tsiliyannis, Richard Dobson, Peter Rudi-Meyer, Kelvin Saunders, Athol Franz, Nic Voutsas, Frant Isak Staud, Richard Brook, Christiaan David • Photographs supplied by Morgenster Estate, Ardmore Ceramic Art, Knysna Tourism, Akorn Tours, Photo Access, iStockphoto • Styling: Barbara McGregor • Models: Luke Dollinger, Lisette Forsyth • Maps: Rob House, Map Studio • Illustrations: Eric North • Clothing and Shoes: Philosophy, Woolworths, Fabiani, Nina Roche • Luggage: Louis Vuitton, Cape Cobra • Jewellery: Peter Gilder • DTP: Barnard Oosthuizen • Printing: Trident Press



Thank You

On the occasion of our 10th anniversary I wrote: 'At 40 I was well off. At 53 I'm broke. But boy, have I got a great train set!' Ten years later nothing much has changed.

The fact that Rovos Rail is in existence today is attributable to many factors, but none so important as the input from friends and family who have unselfishly given their time, advice and financial assistance. I will not forget. Total belief in one's own capabilities is one thing, but belief in someone else's dreams is a completely different matter.

Thank you Anthea and the family for your dedication and unwavering support. To our agents far and wide without whom we would not have achieved this goal, to our staff who have loyally sweated the years away, and to our wonderful guests who have supported this project – a great thank you!

Richard Vos



ST JAMES MANOR



ST JAMES SEAFORTH



VIEW OF KALK BAY HARBOUR



THE ST JAMES GUESTHOUSES

THE ST JAMES MANOR AND ST JAMES SEAFORTH –
TWO FIVE STAR SEASIDE RETREATS OVERLOOKING
THE TRENDY AND VIBRANT FISHING VILLAGE OF
KALK BAY WITH MAJESTIC VIEWS ACROSS
FALSE BAY AND THE INDIAN OCEAN

St James, historically known as 'millionaire's mile' is making its comeback as one of the trendiest places to stay in Cape Town. The area still boasts the traditional colourful Victorian bathing boxes and grand old houses. Fresh fish can be brought from the local fishermen and the harbour itself offers excellent seafood restaurants from rustic local cuisine to fine-dining experiences. Mediterranean in style, the main road is a hive of novel antique shops, delis, boutiques and art galleries a mere ten-minute walk from the guesthouses. Across the road you will find the famous tidal pools and swimming beaches; a favourite pastime is the early morning swim in the warm waters of St James. The area also offers interesting walks along the historic promenade and up the imposing mountains. Perhaps the biggest attraction is the land based whale watching in season; they appear literally meters from the shoreline and can be seen clearly from the guesthouses.

Built a hundred years ago, the St James Manor has an aura of grandeur and old world charm. A magnificent staircase leads up to the six large suites, individually decorated to reflect the opulent times of a bygone era. And carved into the mountain is a private and wind protected swimming pool and tanning deck with views across False Bay.

St James Seaforth was originally built in 1877 and destroyed by fire in 1939. It was rebuilt in its current position in 1940 with extensive views over the bay. The house has now been refurbished to create a contemporary guesthouse with a casual but elegant atmosphere in keeping with its seaside village location. The three upstairs en-suite bedrooms are engaging and stylish as are the spacious downstairs facilities.

Breakfasts are a speciality offering a wide choice of interesting fare and are inclusive, as are all beverages. Dinners and lunches are available by arrangement.

